

Flexit L18 X

Art.no.	Type
14631	L18 XE 400V
14635	L18 XW



SP400 Control Panel included in all units.

	L18 XW	L18 XE
Rated voltage:	230 V	400 V
Fuse:	1 x 10 A	3 x 20 A
Rated current, total:	8 A	19 A
Rated power, total:	1 800 W	12 300 W
Rated power, electric battery:		10 500 W
Rated power, fans:	2 x 550 W	2 x 550 W
Rated preheating power:		
Fan type:	F-wheel	F-wheel
Fan motor control:	Transformer	Transformer
Max. fan speed:	1 220 rpm	1 220 rpm
Filter type (SUP/EXTR):	F 7	F 7
Filter dimensions (W x H x D):	2 x (813 x 548 x 300 mm)	2 x (813 x 548 x 300 mm)
Number of bags:	14	14
Weight:	320 kg	320 kg
Duct connection:	Ø400 mm	Ø400 mm
Height:	1 400 mm	1 400 mm
Width:	2 060 mm	2 060 mm
Depth:	900 mm	900 mm

Flexit L18 X

Accessories



Bag Filter
Art.no. Type
12350 F7



3-way Valve
Art.no. Type
57228 KVS 2,5 3-way
56433 KVS 2,5 2-way
56072 fittings KVS 2,5
56233 KVS 4.0 3-way
56434 KVS 4.0 2-way



Motor 3-way Valve
Art.no.
56234



Closing Air Damper w/Spring Return
Art.no. Type
14479 Ø400 on/off
14480 Ø400 spring return



SP440 CO₂
Art.no.
09359



SP 435 Motion Detector
Art.no.
09358



SP 450 Motion Detector
Art.no.
09390



CC 1050 Pressure Sensor
Art.no.
09367



SP 445 Smoke Detector
Art.no.
09362

Accessories, automatic SP400



SP 405 Week Timer
Art.no. 09297



SP 415 Forcing Switch
Art.no. 09299



SP 420 Heat Control Switch
Art.no. 09294



RM 400 Refrigeration Control
Art.no. 09356

Flexit L18 X

L18 XWR

System drawing, water-based heating

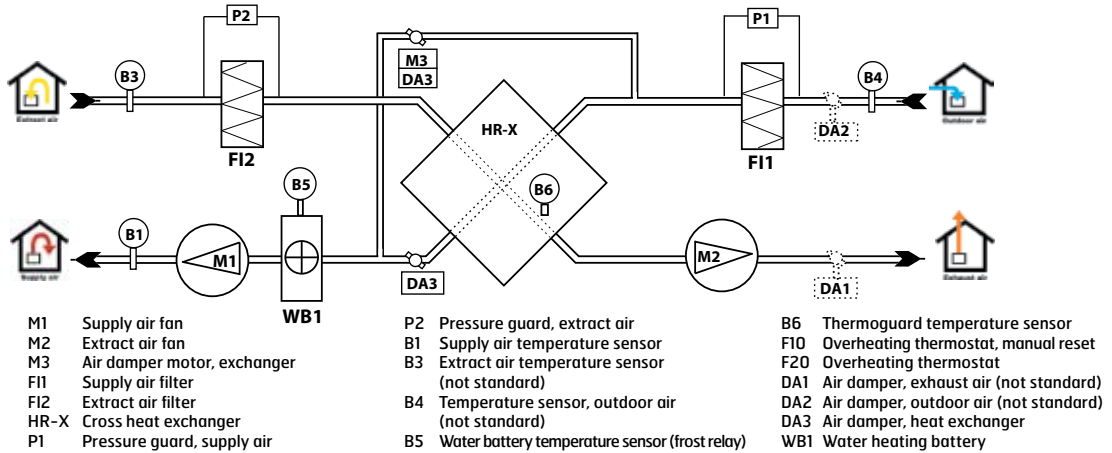

L18 XER

System drawing, electric heating

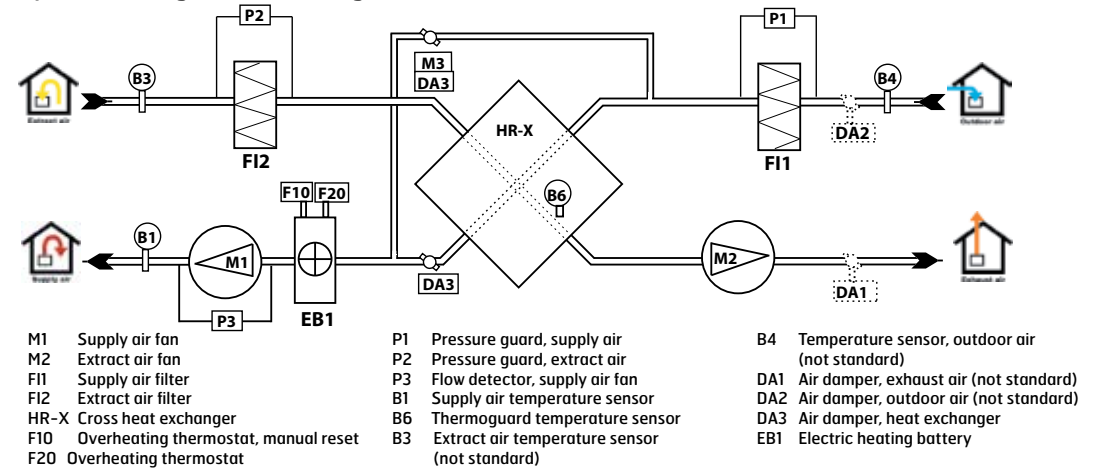

Flexit L18 X

Dimensioned drawing

Dimensions in mm

L18 XW (water-based heating)

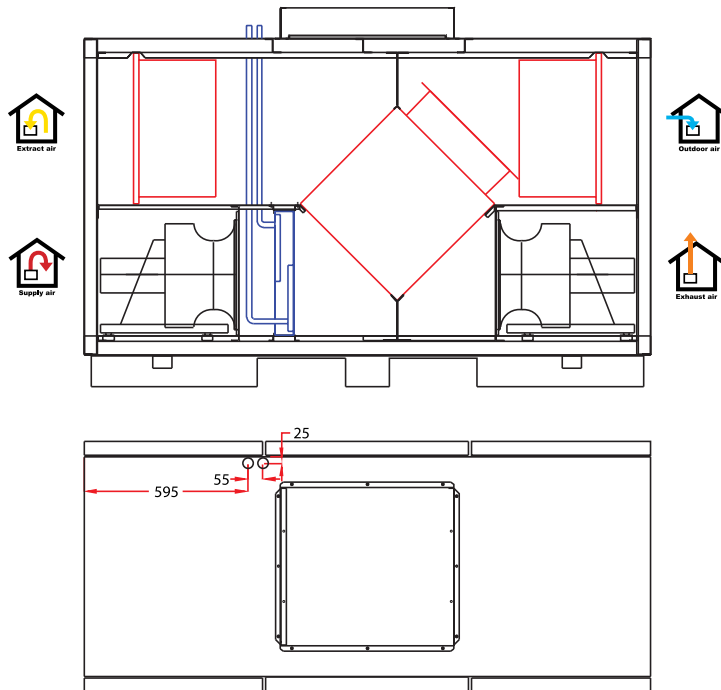

L18 XE (electric heating)

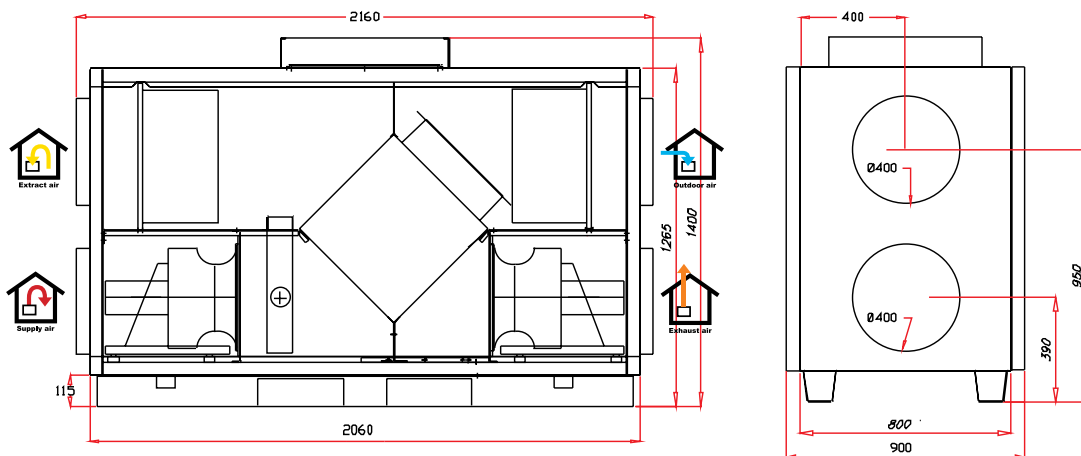

NB! The unit has 2 doors on each side so that it can be operated from either side. The dimensions are the same on both gable sides.

Flexit L18 X

Capacity Diagram L18 W/X (measured with an F7 filter)

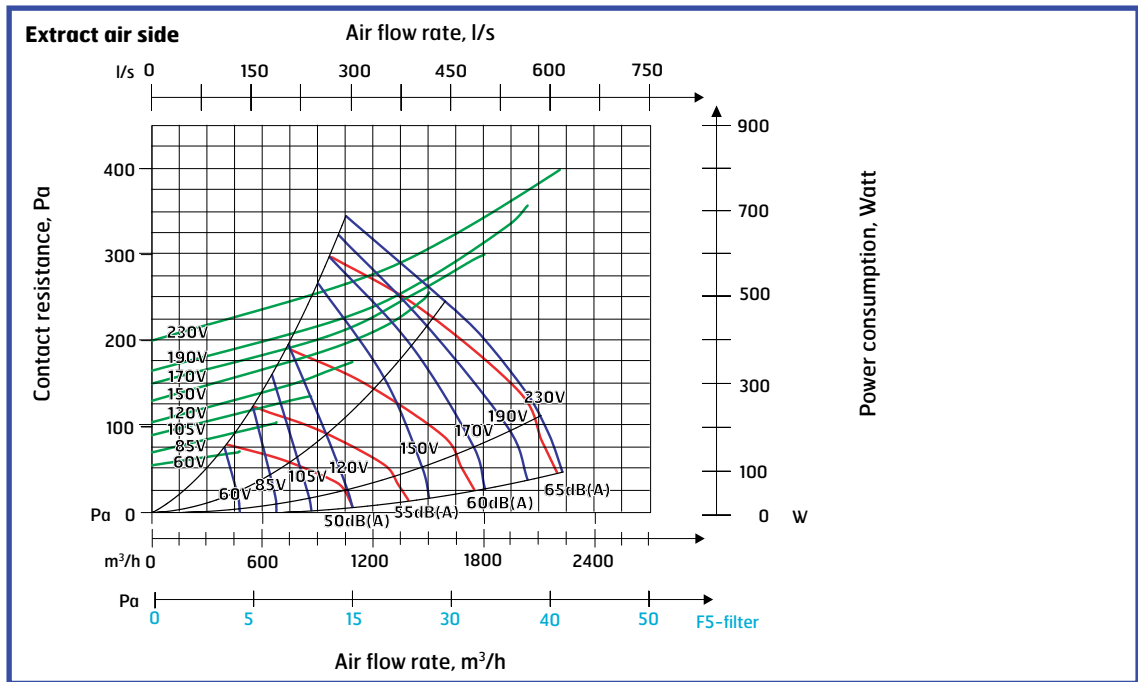
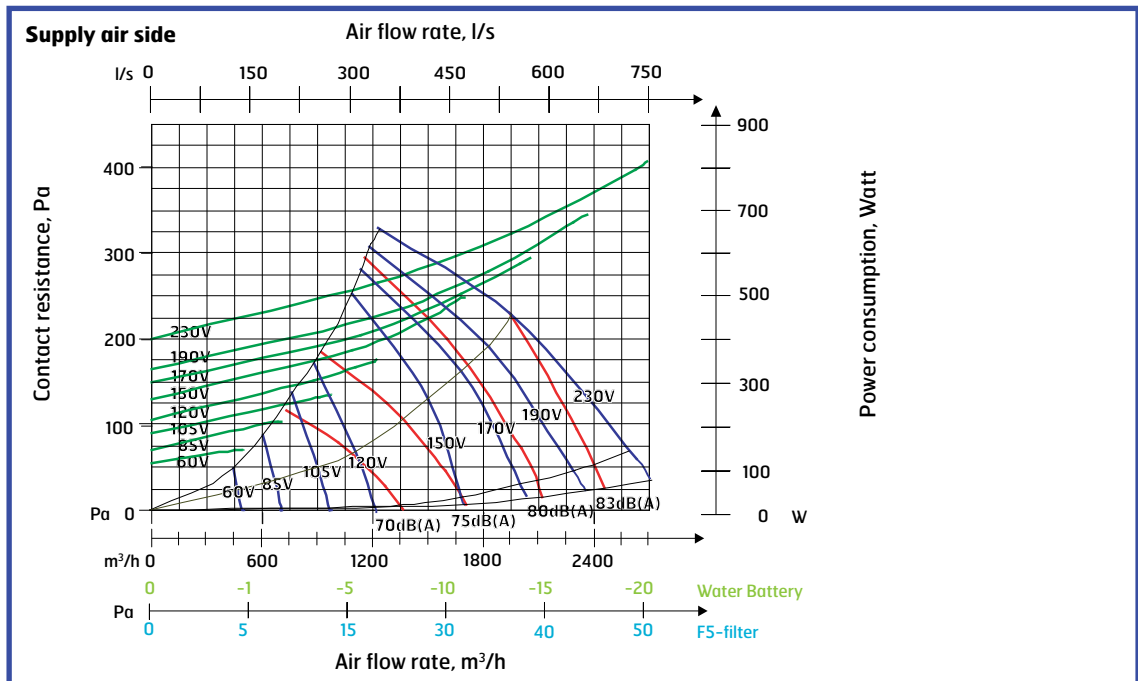

Sound data is given at sound power level L_{wA} in the capacity diagrams and is corrected with the table below for the various octave bands. Radiated noise produces L_w in the various octave bands and total L_{wA} . Radiated noise is calculated by taking the noise value from the supply air table and deducting the total value from the correction factor table.

Supply air data is measured in accordance with ISO 5136, the in-duct method. Radiated noise is measured in accordance with ISO 9614-2. Bruel & Kjaer measuring equipment, type 2260.

Correction factor for L_w									
Hz	63	125	250	500	1000	2000	4000	8000	Total L_{wA}
Supply air	6	0	-3	-2	-4	-11	-16	-24	
Extract air	15	2	-5	-2	-4	-21	-51	-55	
Radiated	-40	-40	-33	-31	-28	-29	-33	-44	-23,7

Blue curves: Air capacity at various capacity settings in Volt.
Green curves: Supply air fan power consumption at various capacity settings.
Red curves: Sound power level L_{wA} , cf. correction table.
Light blue correction axis: Pressure increase using an EU-5 filter.
Light green correction axis: Pressure increase using water battery.