

CONTENT:

SEF certified smoke extraction fan



www.exhausto.com

EXHAUSTO



Description

SEF certified smoke extraction fan

SEF smoke extraction fan with vertical exhaust is approved for temperatures up to 400°C for 120 min.

SEF and TGKS roof cowl has been tested and approved as a general operations fan and evacuation fan in accordance with EN12101-3:2003. Certificate: 0402-CPD-453701

SEF is made of die-cast aluminium and surface treated with hammer varnish, which makes it light, mechanically strong and extremely resistant to corrosion. The motor is a temperature resistant, sealed asynchronous motor with lifetime lubricated ball bearings. This ensures a long service life, high efficiency and low noise levels.

SEF is supplied as standard with vibration damper, armoured cable, mineral wool mat and safety screws which ensure the fan stays attached to the roof cowl whatever the weather or conditions.

SEF smoke extraction fan

	SEF250-4-3	SEF315-4-3	SEF400-4-3	SEF450-4-3
Power supply	3 x 400 V			
rpm	1400	1400	1400	1400
Amp	0.4	1.1	1.3	3.4
kW	0.10	0.32	0.42	1.5
Weight, kg	26	35	44	66

SEF smoke extraction fan

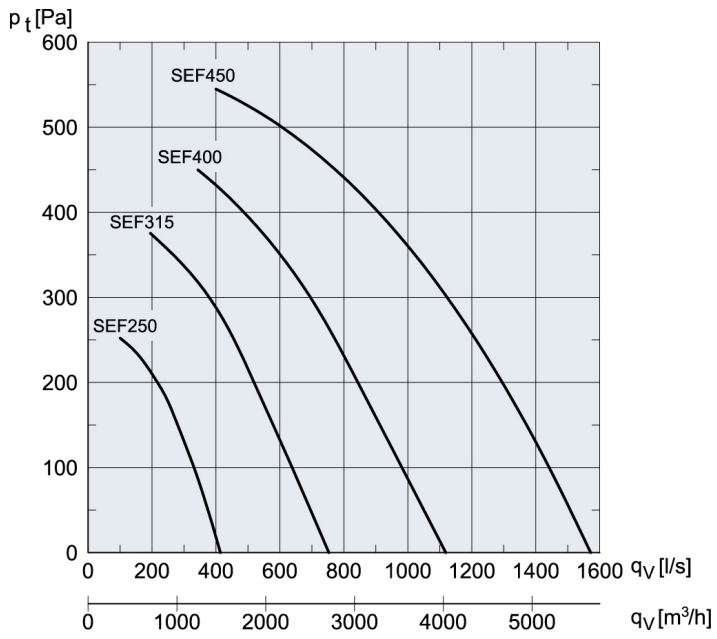

SEF smoke extraction fan

	SEF250-4-3	SEF315-4-3	SEF400-4-3	SEF450-4-3
125 Hz	64	71	76	78
250 Hz	68	75	80	86
500 Hz	68	70	75	77
1,000 Hz	85	73	79	81
2,000 Hz	61	68	74	74
4,000 Hz	49	57	62	65
8,000 Hz	45	52	57	58
Lp dB(A)	41	48	53	56

Lw = sound output level dB (reference: 1 pW)

Lp = sound output level dB (A) at 10 m distance from the fan with semi-spherical sound dissipation

Lp (5 m) = Lp (10 m) + 6 dB

Lp (20 m) = Lp (10 m) - 6 dB

Tolerance +/-3 dB

SEF smoke extraction fan

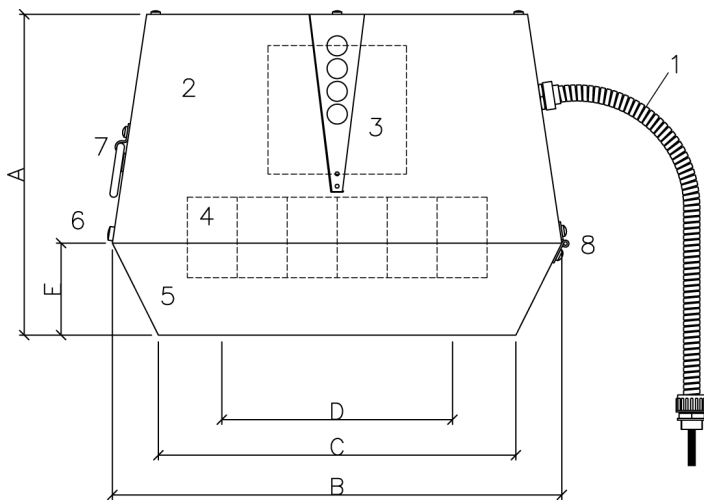

	SEF250-4-3	SEF315-4-3	SEF400-4-3	SEF450-4-3
A mm	335	380	430	645
B mm	485	580	650	650
C mm	385	485	525	525
D Ømm	250	315	400	400
E mm	100	115	130	220

1. Connecting cable
2. Top section
3. Motor
4. Centrifugal impeller
5. Bottom section
6. Safety screws
7. Handle
8. Hinges

SEF smoke extraction fan

The fan is fitted onto the roof cowl using the supplied vibration dampers. This ensures vibration-free operation, while the mineral wool mat positioned on the spigot forms a seal between the fan and the roof cowl. The safety bolts are fitted in the roof cowl.

The TGKS roof cowl is composed of galvanised sheet metal, 50 mm mineral wool that insulates against sound and condensation, mesh, and an inner housing of perforated galvanised sheet metal.

SEF can also be mounted on an existing roof cowl using an FPTS mounting panel.



EXHAUSTO

Your ventilation expert and professional business partner

At EXHAUSTO we never compromise on quality, and since we are experts in ventilation with many years of specialised experience, you can be assured of not just the best ventilation solution but also a competent business partner.

EXHAUSTO develops and manufactures high-quality products and systems for comfort ventilation in all areas of use – from offices, shops, schools and institutions to industrial buildings, hotels and hospitals. With a focus on high efficiency ratings and an energy consumption which sets new industry standards, EXHAUSTO is one of the absolute leaders of the field.



www.exhausto.com

EXHAUSTO, Export
Odensevej 76
DK-5555 Langeskov

EXHAUSTO